



# Clayworks

## DESIGN DETAILS

for Clayworks Clay Plaster Finishes

Natural Clay Plasters

# Clayworks

## DESIGN DETAILS

We work with Clayworks Approved Plasterers.

We strongly recommend that they are used to install our products.

### TECHNICAL GUIDANCE:

- Substrates to be structurally sound and solid to prevent movement.
- Non-flat or curved substrates may require different substrate preparation – please enquire.
- All beads and trims to be set in with gypsum plaster or bonding agent, prior to application of Clayworks (for internal clay plasters). Approved Plasterer to advise for Tadelakt and Exterior finishes.
- All beads and trims to be primed with Clayworks Primer prior to application of Clayworks (for internal clay plasters). Approved Plasterer to advise for Tadelakt and Exterior finishes.
- All beads, trims and mesh and ancillaries to be specified and supplied by Approved Plasterer.
- Approved Plasterer to check suitability of substrates and advise regarding required preparation.
- These guidelines are for design and construction planning purposes only.

### LIMITATIONS:

- Clay products are not suitable for floors or stair treads.
- Clayworks internal clay plasters are well suited for bathrooms, kitchens and rooms with occasional high humidity. However they are not suitable for wet areas with direct water contact (e.g. shower enclosures or behind a sink without a splash-back). See our Tadelakt finish where a waterproof finish is required.
- Clayworks internal clay plasters are for internal use only. See our Exterior finishes where an external finish is required.

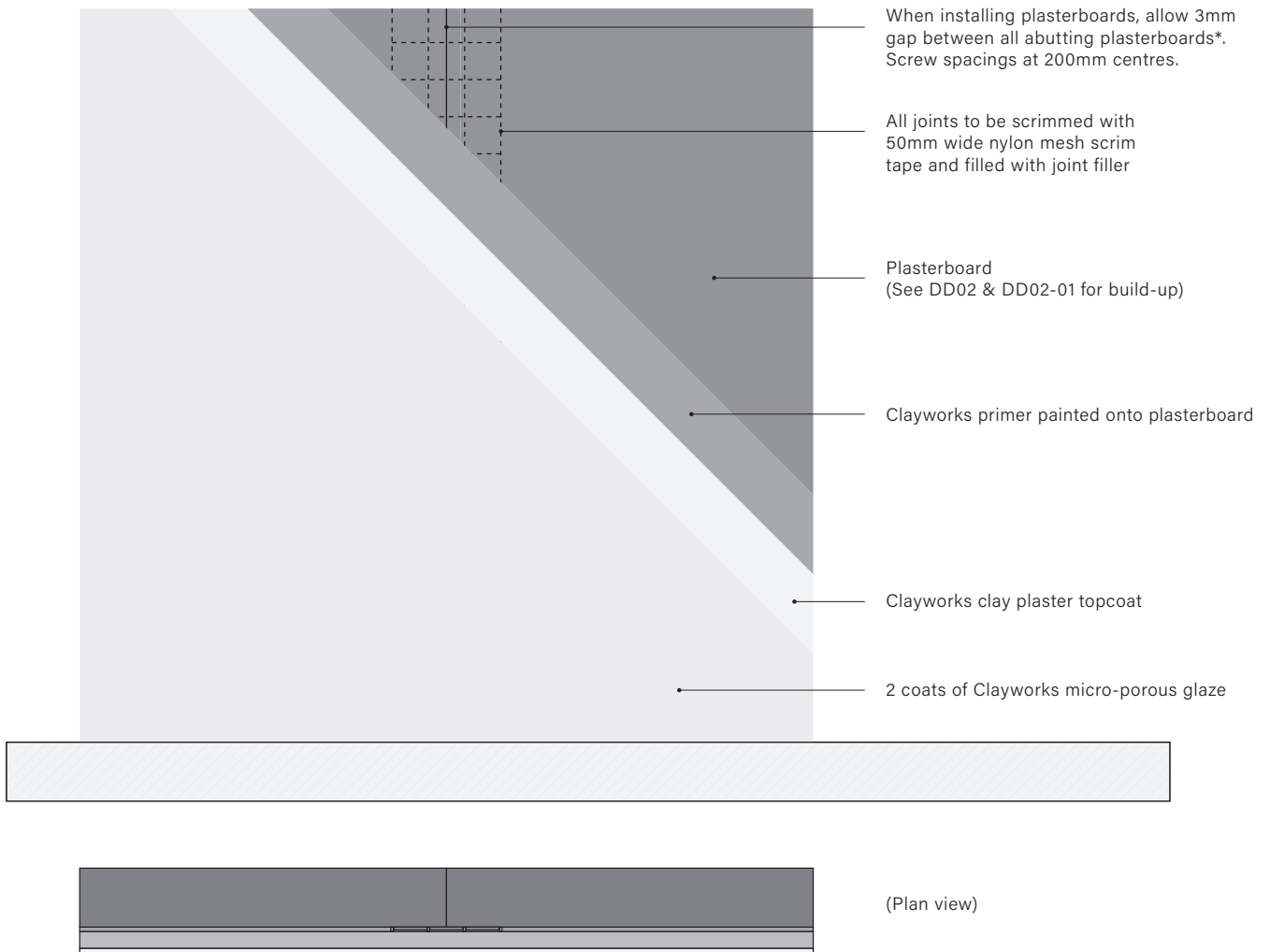

## Notes

\* Alternatively to 3mm gaps, a gypsum skim can be applied to the whole surface prior to the Clayworks primer.

All internal corners to be scrimmed with mesh tape - do not use paper tape for jointing as it can delaminate.

All screws to be filled with joint filler.

Substrates to be structurally sound and solid to prevent movement.

These guidelines are for design and construction planning purposes only.

Approved Plasterer to confirm build-up and specifications.

Approved Plasterer to specify and supply all trims & beading etc.

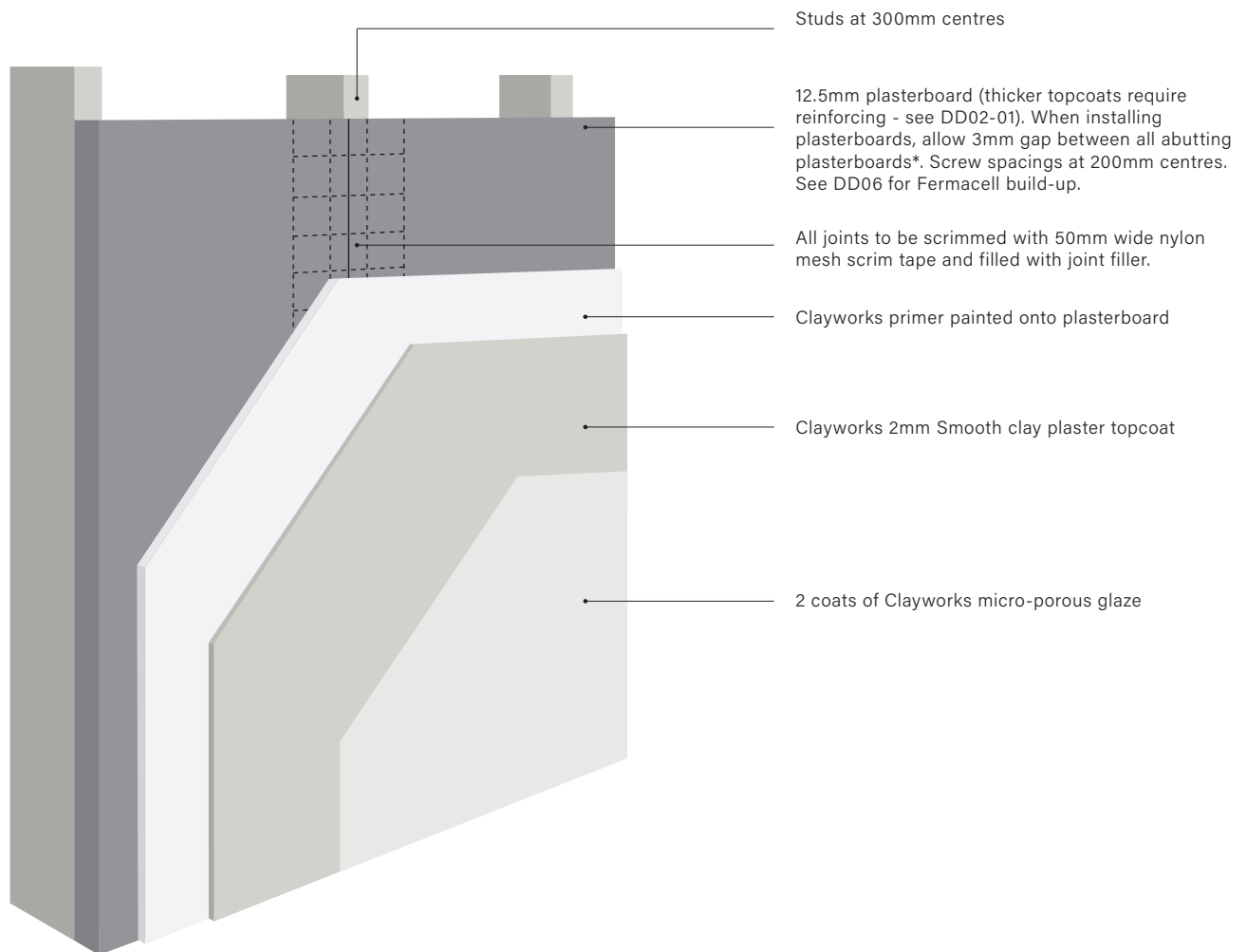

## Notes

\* Alternatively to 3mm gaps, a gypsum skim can be applied to the whole surface prior to the Clayworks primer.

All internal corners to be scrimmed with mesh tape - do not use paper tape for jointing as it can delaminate.

All screws to be filled with joint filler.

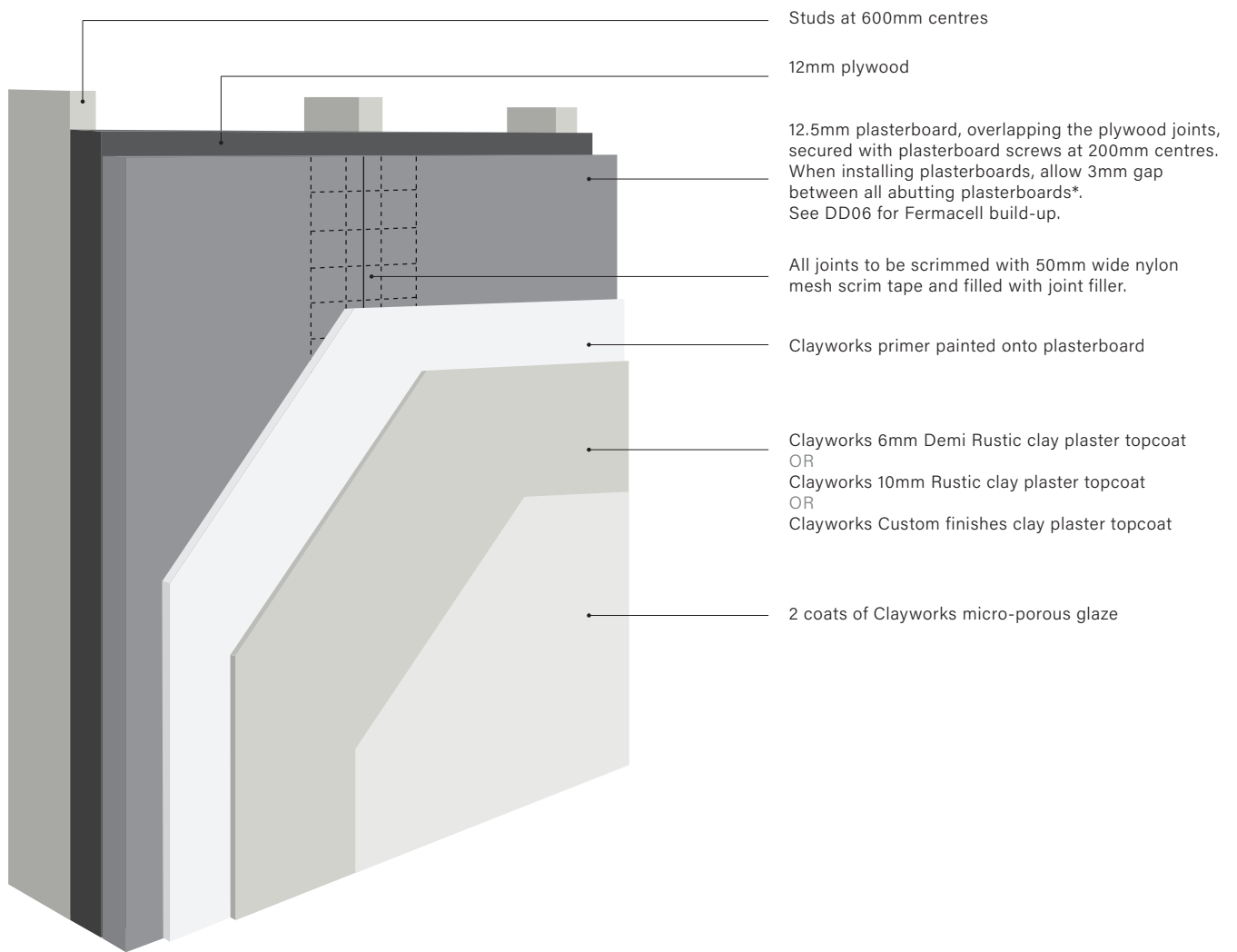

## Notes

---

\* Alternatively to 3mm gaps, a gypsum skim can be applied to the whole surface prior to the Clayworks primer.

All internal corners to be scrimmed with mesh tape - do not use paper tape for jointing as it can delaminate.

All screws to be filled with joint filler.

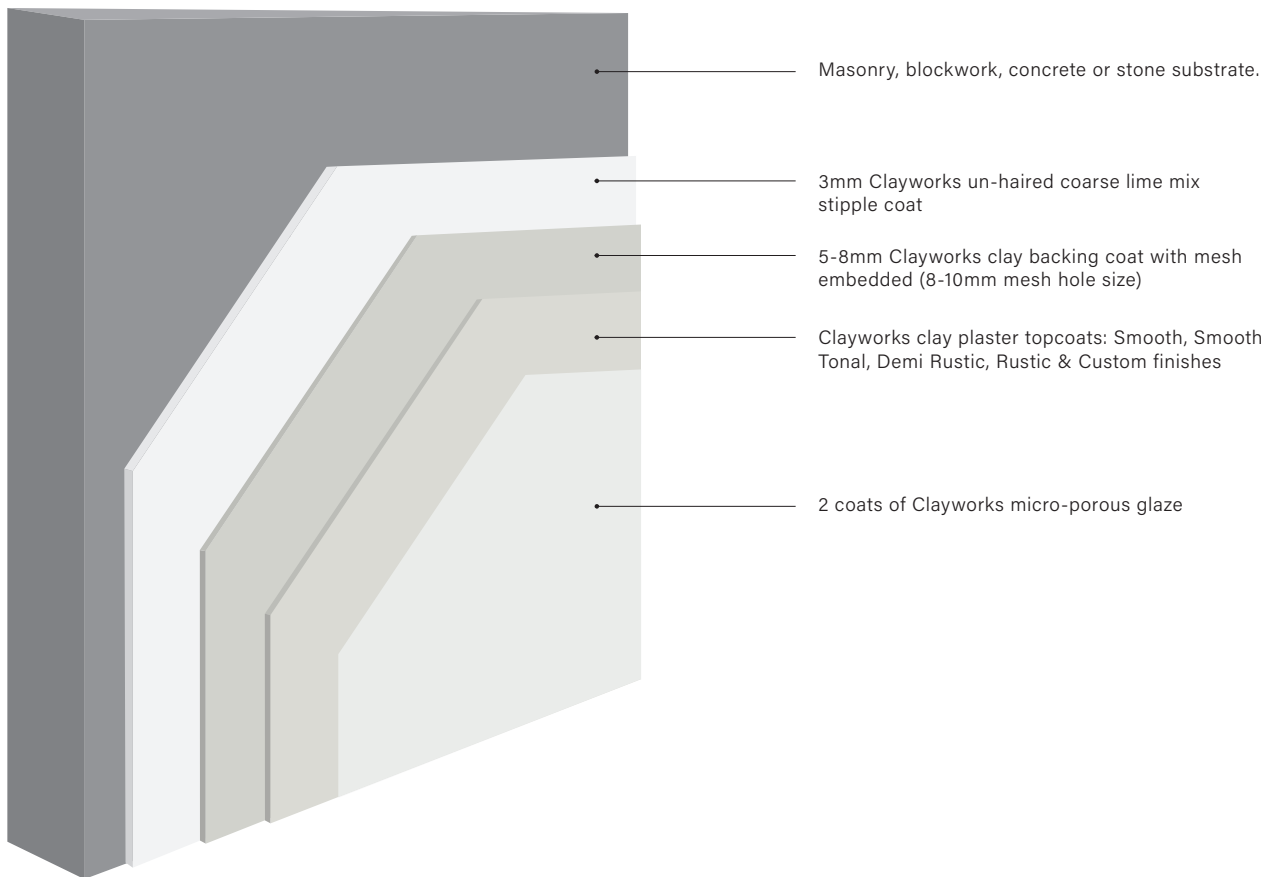

#### Notes

---

Approved Plasterer to check suitability of substrates and advise regarding required preparation.

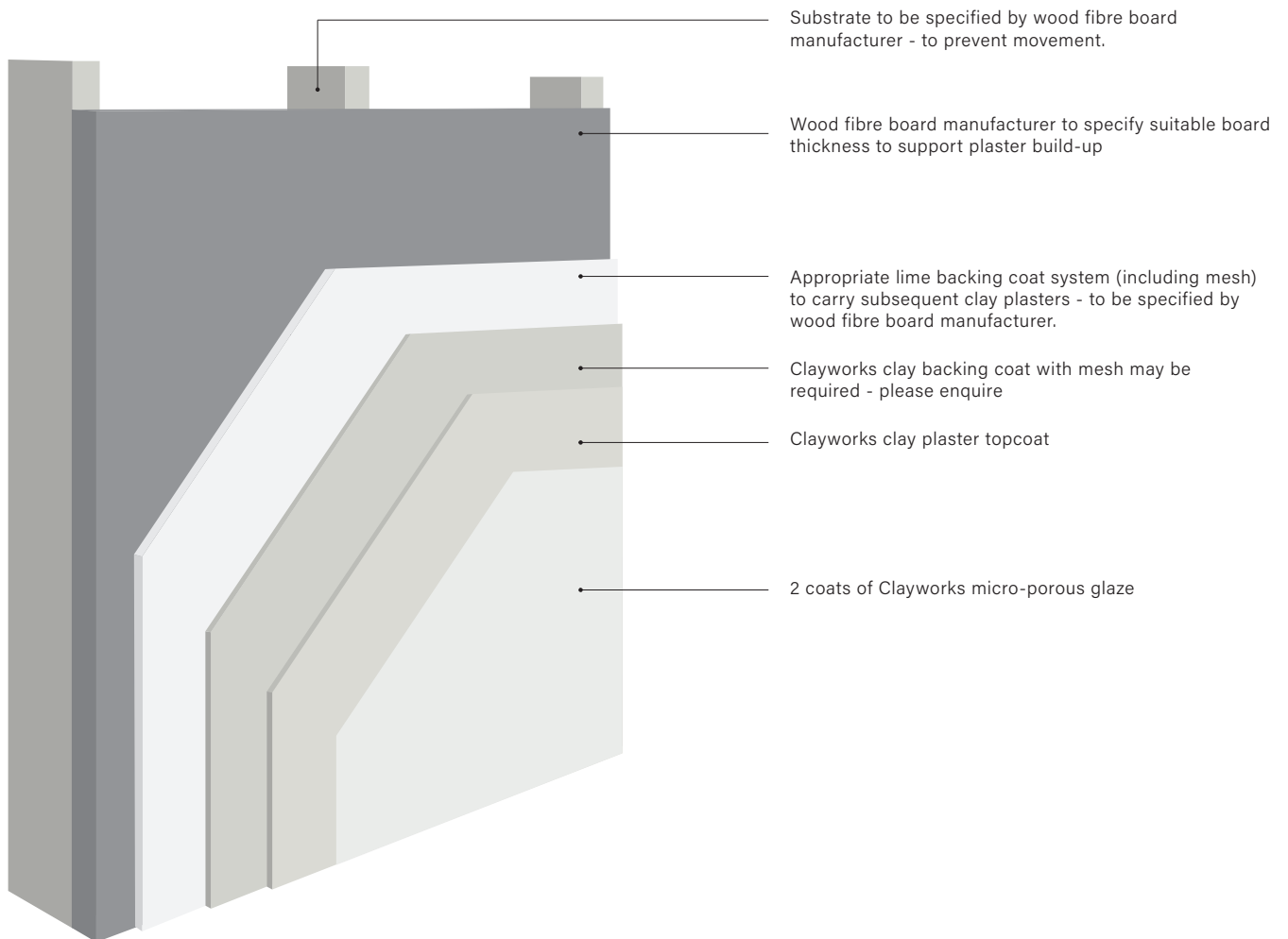

### Notes

---

All internal corners to be scrimmed with mesh tape - do not use paper tape for jointing as it can delaminate.

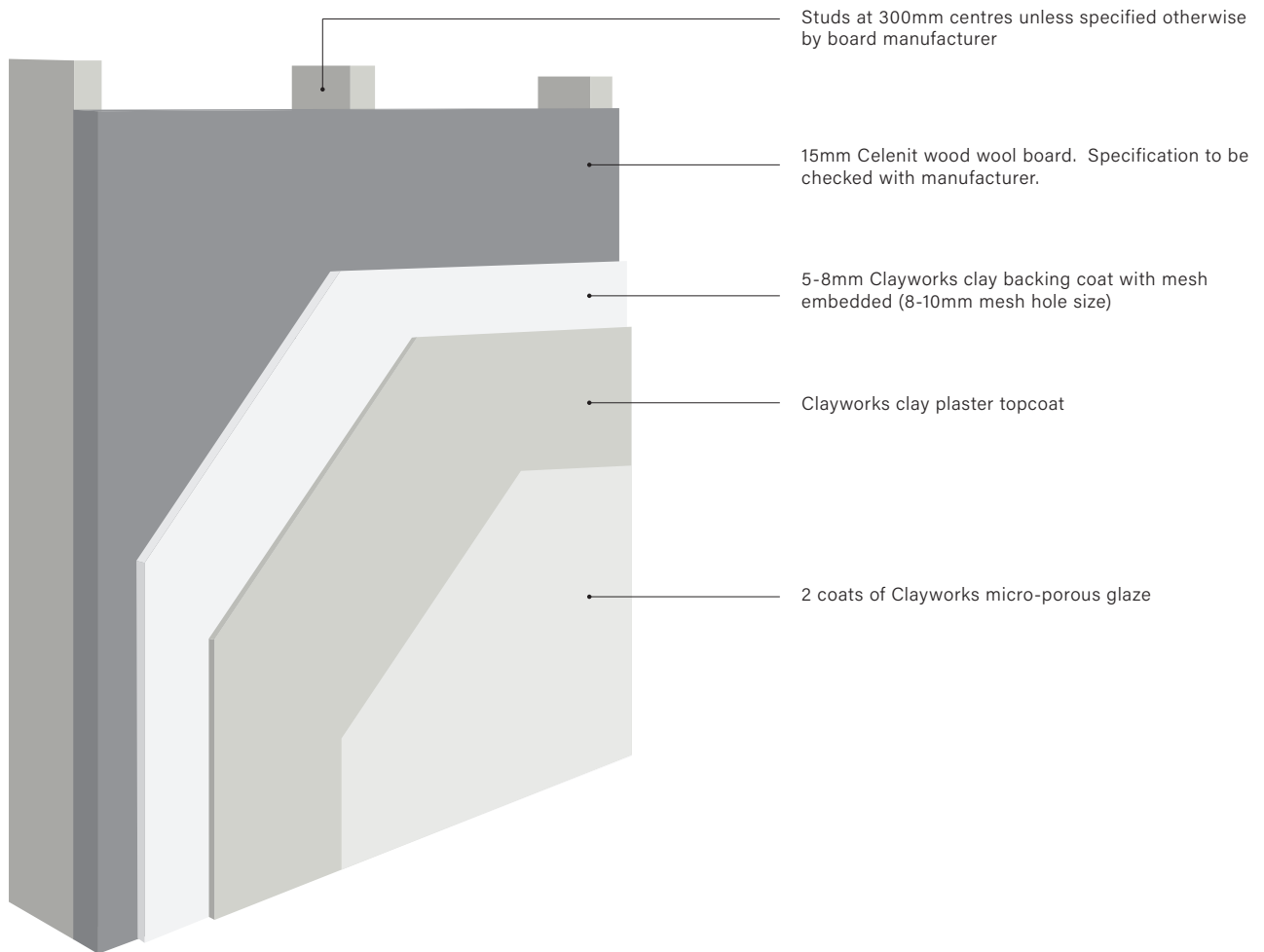

#### Notes

---

All internal corners to be scrimmed with mesh tape - do not use paper tape for jointing as it can delaminate.



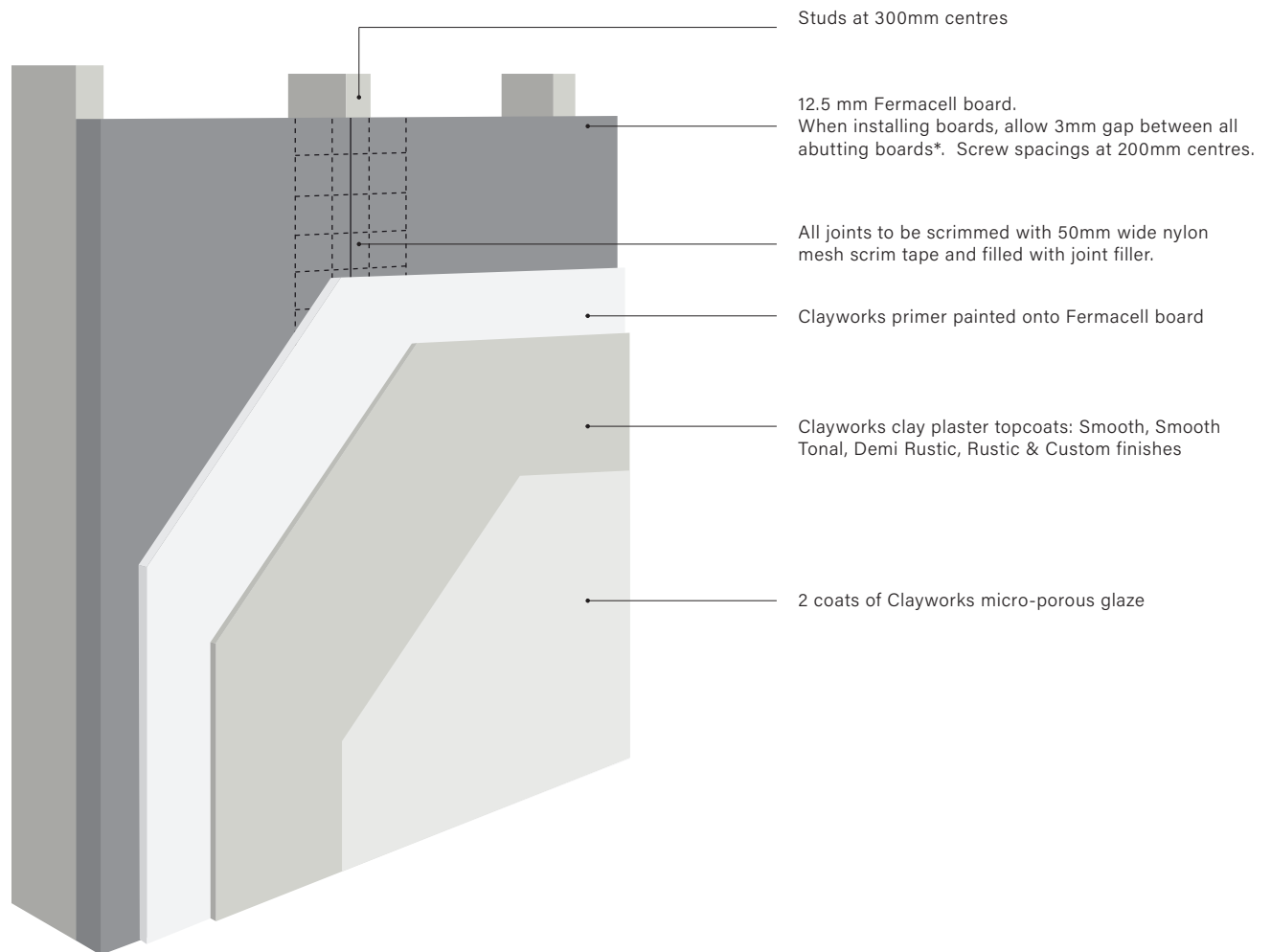

## Notes

---

\* Alternatively to 3mm gaps, a gypsum skim can be applied to the whole surface prior to the Clayworks primer.

All internal corners to be scrimmed with mesh tape - do not use paper tape for jointing as it can delaminate.

All screws to be filled with joint filler.

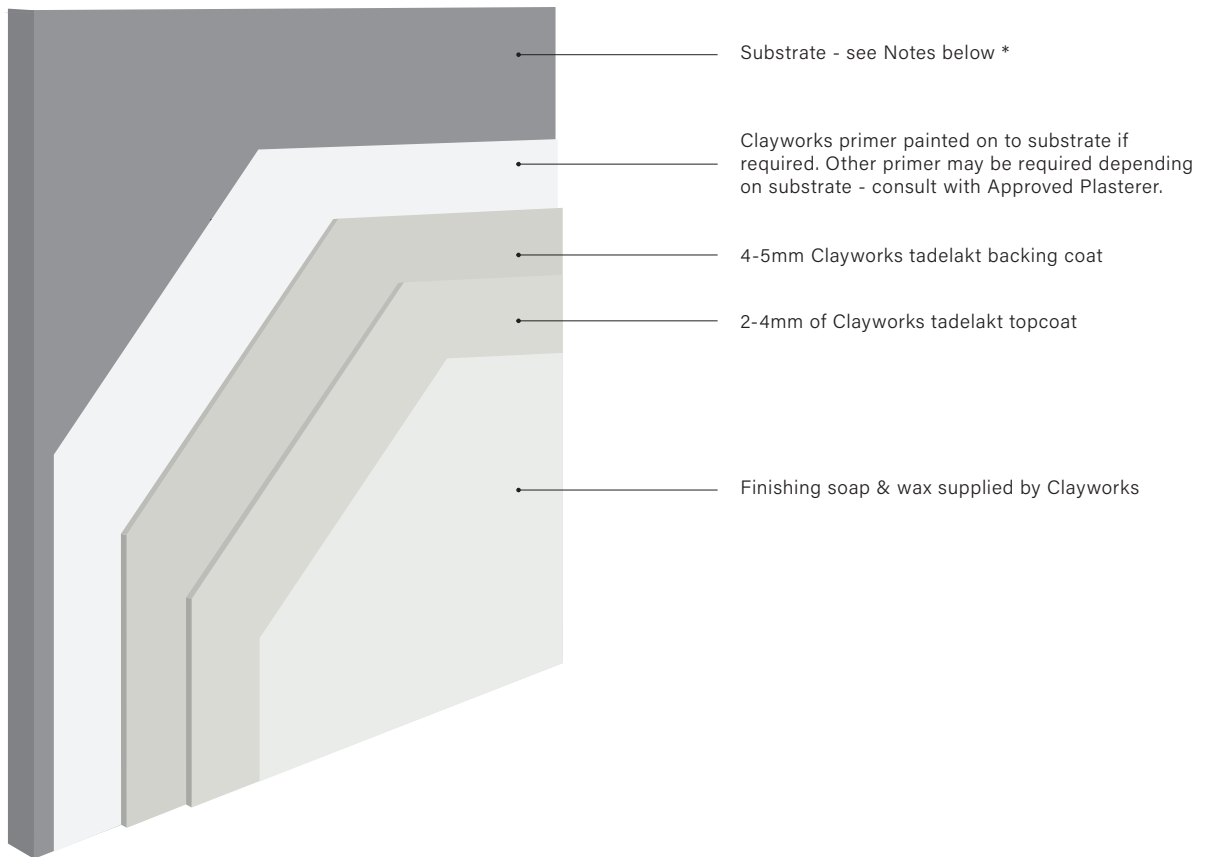

## Notes

\* **Plasterboard substrate:** (moisture resistant plasterboard to be specified). Plasterboard joints to be taped and filled. Plasterboard to have 12mm plywood backing behind. Stud wall behind to have studs at 300mm centres.

**Fermacell:** check with manufacturer for recommended specification.

**Tile backing board substrates:** to receive Stonefix or similar backing coat system with mesh embedded. Consult with Approved Plasterer. Board to be specified by manufacturer.

**Blockwork, masonry and other substrates:** consult with Approved Plasterer.

Approved Plasterer to check suitability of substrates and advise regarding required preparation.

These guidelines are for design and construction planning purposes only.

**Clayworks Tadelakt finish is not suitable for floors.**

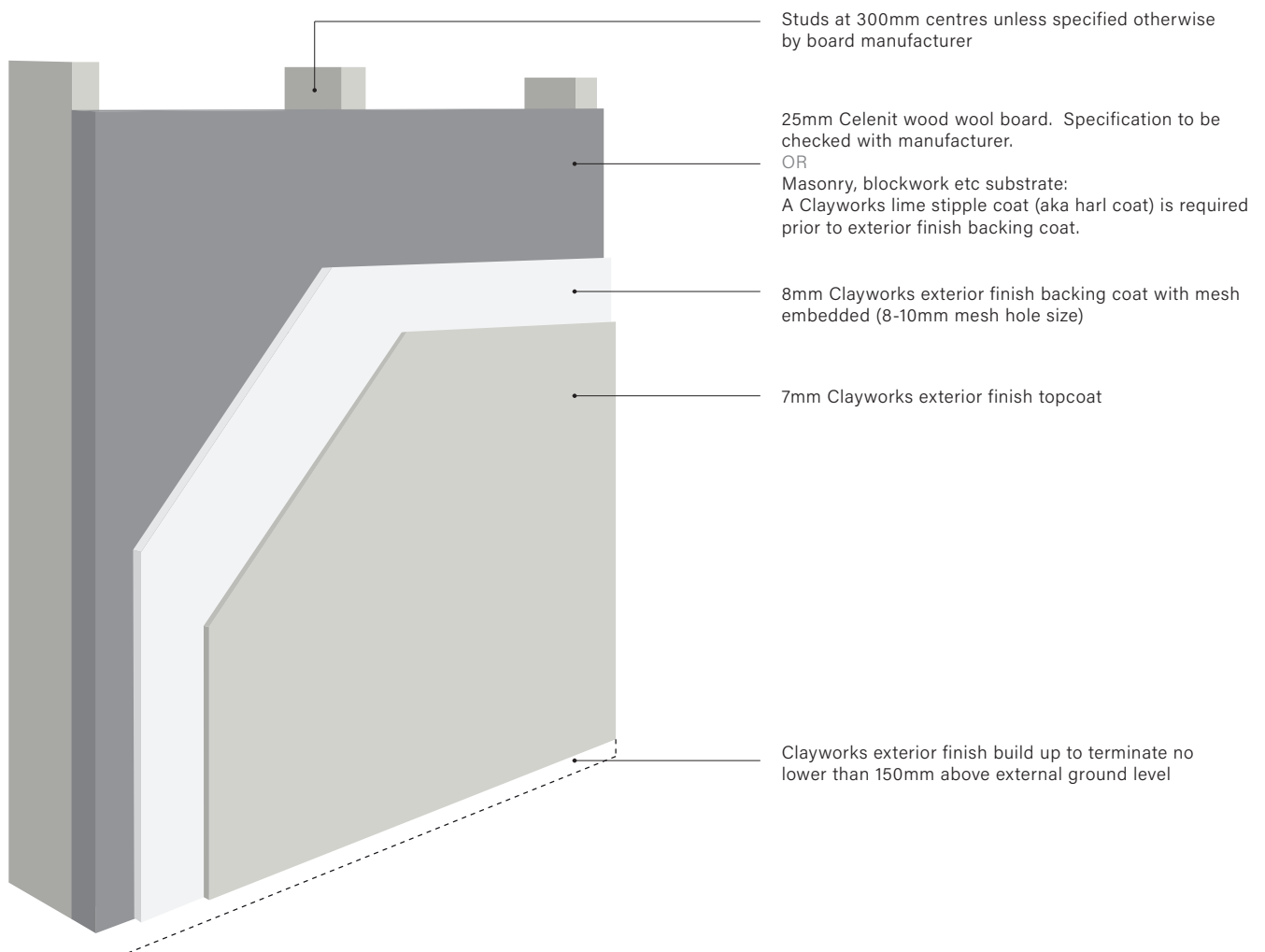

## Notes

Approved Plasterer to check suitability of substrates and advise regarding required preparation.